

REPLACEMENT INSTRUCTIONS

12. Test connector for full range of motion and sealing ability.

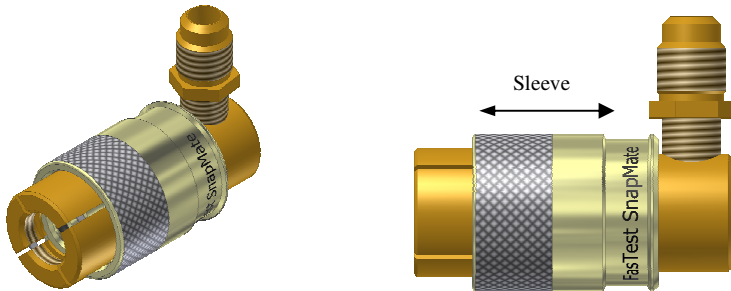

CONNECTOR MAINTENANCE:

- A daily, weekly and periodic inspection of the connector by competent person is recommended.
- User must establish a regular interval for maintenance as determined by the user media and operational environment.
- Inspection should include checking for damage to all components, loose components, leak tightness, ease of operation, sufficient lubrication, wear and dirt accumulation.
- Inspect threads for wear.
- Use only original **FastTest** spare parts that are designed for the application and are subject to strict quality control. See Warranty.
- Lubricate with petroleum based jelly.

FasTest, Inc. Product Warranty

FasTest, Inc. warrants its products against defects of workmanship and/or material for 12 months from the date of the sale by FasTest, Inc. This warranty is void if the product is misused, tampered with or used in a manner that is not in accordance with FasTest, Inc. recommendations and/or instructions. FasTest, Inc. is not liable for consequential or other damages including, but not limited to, loss, damage, personal injury, or any other expense directly or indirectly arising from the use of or inability to use its products either separately or in combination with other products. ALL OTHER WARRANTIES EXPRESSED OR IMPLIED, WHETHER ORAL OR WRITTEN, INCLUDING BUT NOT LIMITED TO WARRANTIES OR MERCHANTABILITY OR FITNESS FOR A PARTICULAR PURPOSE ARE EXPRESSLY EXCLUDED.

Remedy under this warranty is limited to replacement of the product or an account credit in the amount of the original selling price, at the option of FasTest, Inc. All allegedly defective products must be returned prepaid transportation to FasTest, Inc. along with information describing the products performance, unless disposition in the field is authorized in writing by FasTest, Inc.

SCRA07H Complete Seal Replacement Kit for SnapMate[®] Service Tool

Description: Seal Replacement Instructions for Service Version SnapMate[®]

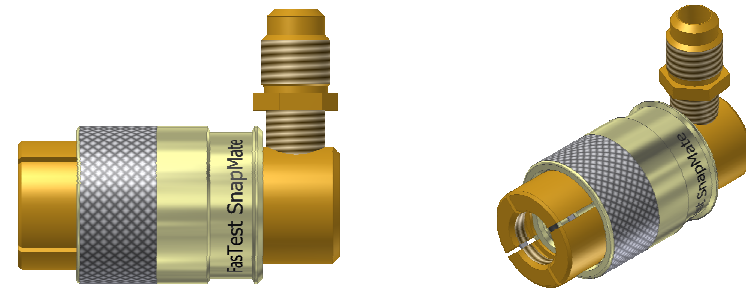

Please thoroughly read the following steps on properly replacing all seals on the SnapMate Service Tool.

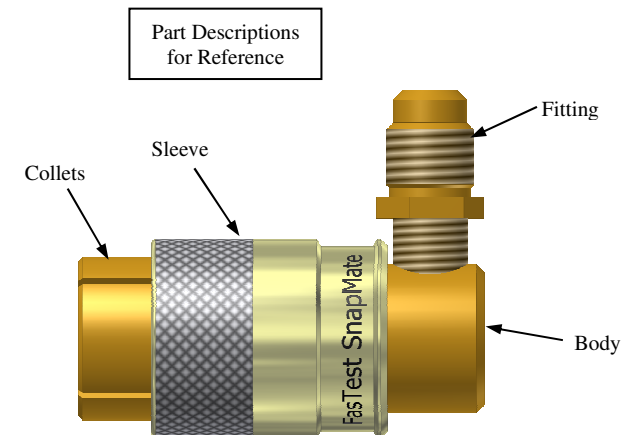

REPLACEMENT INSTRUCTIONS

Seal Replacement Steps:

1. Disassemble the connector.

2. Remove fitting from side port.

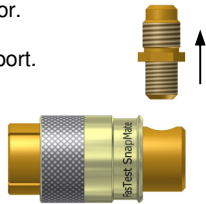

3. Place collets on flat surface as shown and compress the connector by pushing down on body. While it is compressed, slide the sleeve backwards to remove.

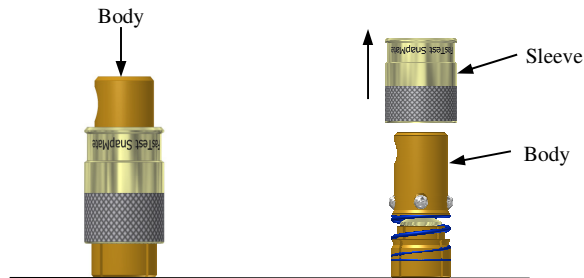

4. Remove collets, piston, spring and balls from the body.

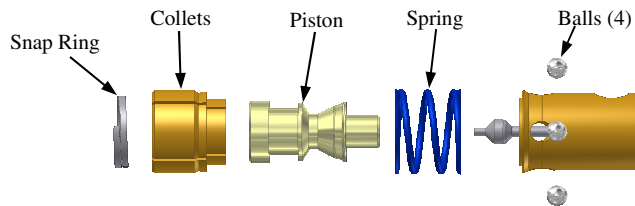

5. Using a repair pick or small screwdriver, remove all seals (o-rings) and discard. Exercise caution not to scratch or damage the o-ring grooves. Take note where each size o-ring was located. This will help in knowing where the replacement o-rings belong.

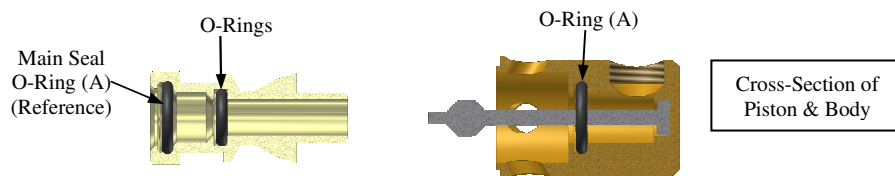

6. O-Rings marked with (A) are the same size. Lubricate all o-rings (except the main seal) with a petroleum based jelly and insert them into their respective grooves.

7. Place snap ring, collets and spring onto the piston.

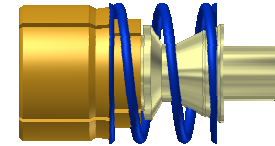

8. Place the collet and piston assembly into the body.

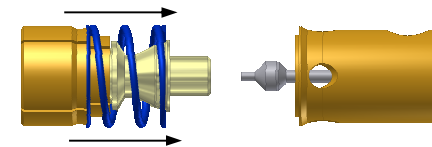

9. Turn the assembly over and push down on the body until spring is completely compressed and insert the balls into the ball holes. A light coating of a petroleum based jelly may aid in retaining the balls.

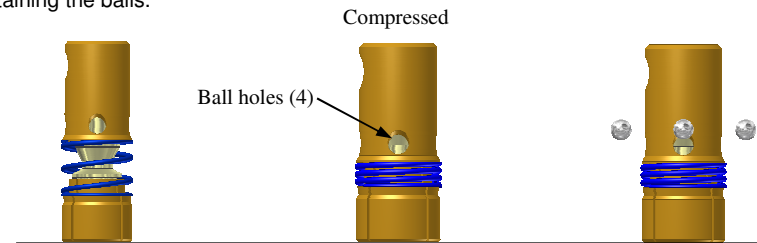

10. After the balls have been inserted, keeping the assembly compressed, slide the sleeve completely over the assembly. The knurling end of sleeve points towards the collets.



11. Apply a small drop of LocTite 242 to the threaded end of fitting and thread in side port on body. Torque the fitting into the body port to 71 in-lbs. Wipe away excess LocTite.

